

## 3M™ Speedglas™ Welding Helmet 9100



### Helmet with auto-darkening lens

Part No	Description
50 18 26	Speedglas 9100XXi welding helmet - complete.



### Helmet without auto-darkening lens

Part No	Description
50 18 00	Speedglas 9100 welding helmet excluding lens, including head harness.



### Auto-darkening welding lens

Part No	Description
50 00 26	Speedglas 9100XXi welding lens.



### Upgrade: 3M™ Speedglas™ Welding Lens Kit 9100XXi

Our top-of-the-line welding lens with improved optics and a specially designed front cover with external controls for grinding and memory modes. This complete kit (front cover and welding lens) is compatible with Speedglas welding helmet models 9100, 9100 Air and 9100 QR.

Read more about the new 9100XXi welding filter on page 9.



**Part No:**  
50 01 26 Speedglas 9100XXi welding lens & front cover kit.

Spare parts & accessories for 3M™ Speedglas™ Welding Helmet 9100

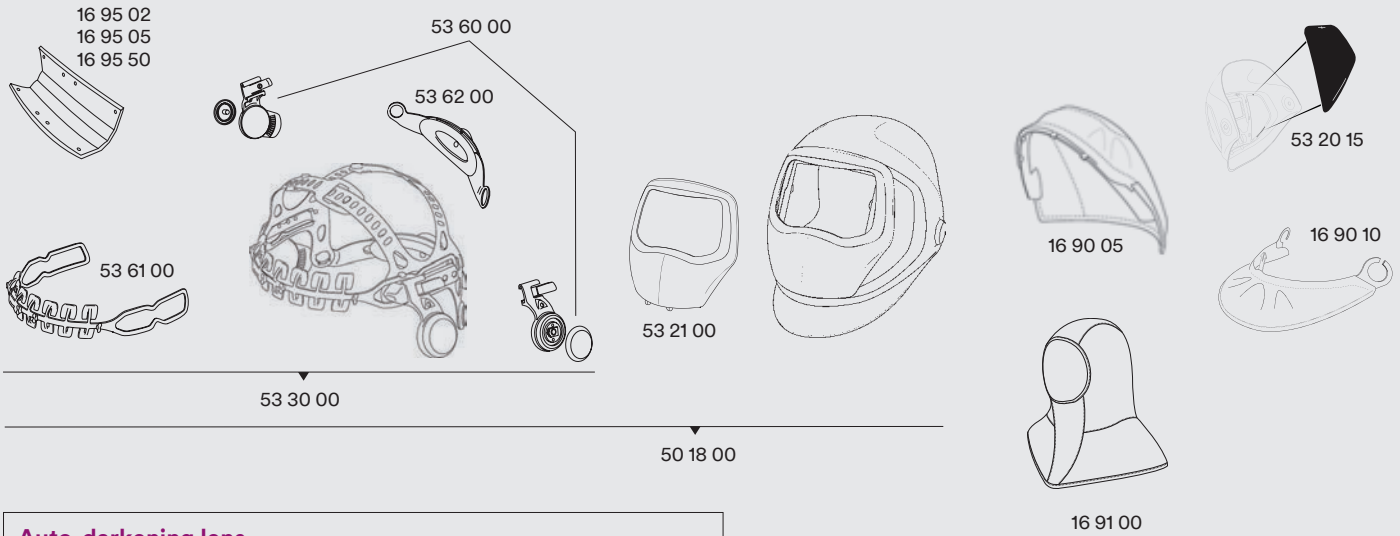

Auto-darkening lens

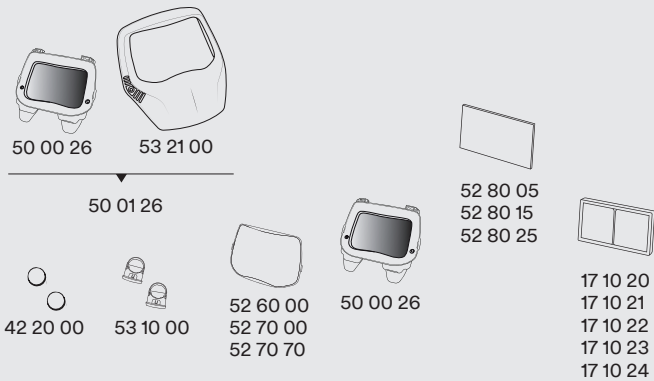

Passive lens option

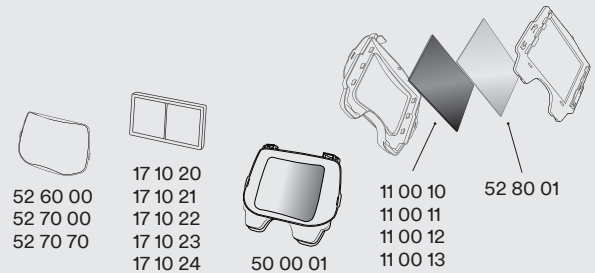

Part No	Description	Part No	Description	Part No	Description
11 00 10	Lens Welding Shade 10 Passive 90X110mm 9100	17 10 23	Lens Magnifying 2.5X 9100, 100 & 9000	52 80 15	Lens Cover Inner 9100X Pk=5
11 00 11	Lens Welding Shade 11 Passive 90X110mm 9100	17 10 24	Lens Magnifying 3.0X 9100, 100 & 9000	52 80 25	Lens Cover Inner 9100XX/XXi Pk=5
11 00 12	Lens Welding Shade 12 Passive 90X110mm 9100	42 20 00	Battery Lithium 9100, 100 & 9000 Pk=2	53 10 00	Holder Battery 9100
11 00 13	Lens Welding Shade 13 Passive 90X110mm 9100	50 00 01	Lens Welding Filter 9100P Shade 11 Passive	53 20 15	Cover Plates SW 9100 Pk=2
16 90 05	Head Protection 9100	50 00 26	Lens Welding 9100XXi Speedglas	53 21 00	Front Cover Silver 9100XXi
16 90 10	Throat Protection 9100	50 01 26	Lens Welding 9100XXi & Front Cover Kit Speedglas	53 30 00	Head Harness 9100
16 91 00	Head Cape Tecaweld	50 18 00	Helmet Welding 9100 Exc Lens	53 60 00	Head Harness Pivot Mechanism 9100
16 95 02	Sweatband 9100 & 9100 FX Pk=2	52 60 00	Lens Cover Outer Standard 9100 Pk=10	53 61 00	Head Harness Front Part 9100
16 95 05	Sweatband 9100 & 9100 FX Pk=5	52 70 00	Lens Cover Outer Hard Coated 9100 Pk=10	53 62 00	Head Harness Back Part 9100
16 95 50	Sweatband 9100 & 9100 FX Pk=50	52 70 70	Lens Cover Outer High Heat 9100 Pk=10		
17 10 20	Lens Magnifying 1.0X 9100, 100 & 9000	52 80 01	Lens Cover Inner 9100 Passive Pk=5		
17 10 21	Lens Magnifying 1.5X 9100, 100 & 9000	52 80 05	Lens Cover Inner 9100V Pk=5		
17 10 22	Lens Magnifying 2.0X 9100, 100 & 9000				

# 3M™ Speedglas™ Welding Helmet 9100 FX



## Helmet with auto-darkening lens

Part No	Description
54 18 26	Speedglas 9100XXi FX welding helmet - complete.

## Helmet without auto-darkening lens

Part No	Description
54 18 00	Speedglas 9100 FX welding helmet excluding lens, including head harness.

## Auto-darkening welding lens

Part No	Description
50 00 26	Speedglas 9100XXi welding lens.

## Flip-up helmet functionality

The Speedglas welding helmet 9100XXi FX gives you a flip-up combination of an auto-darkening welding helmet and protective visor.

Not only is the viewing area larger compared to previous models, we redesigned the geometry of the helmet for a wider field of view in all directions.



Spare parts & accessories for 3M™ Speedglas™ Welding Helmet 9100 FX

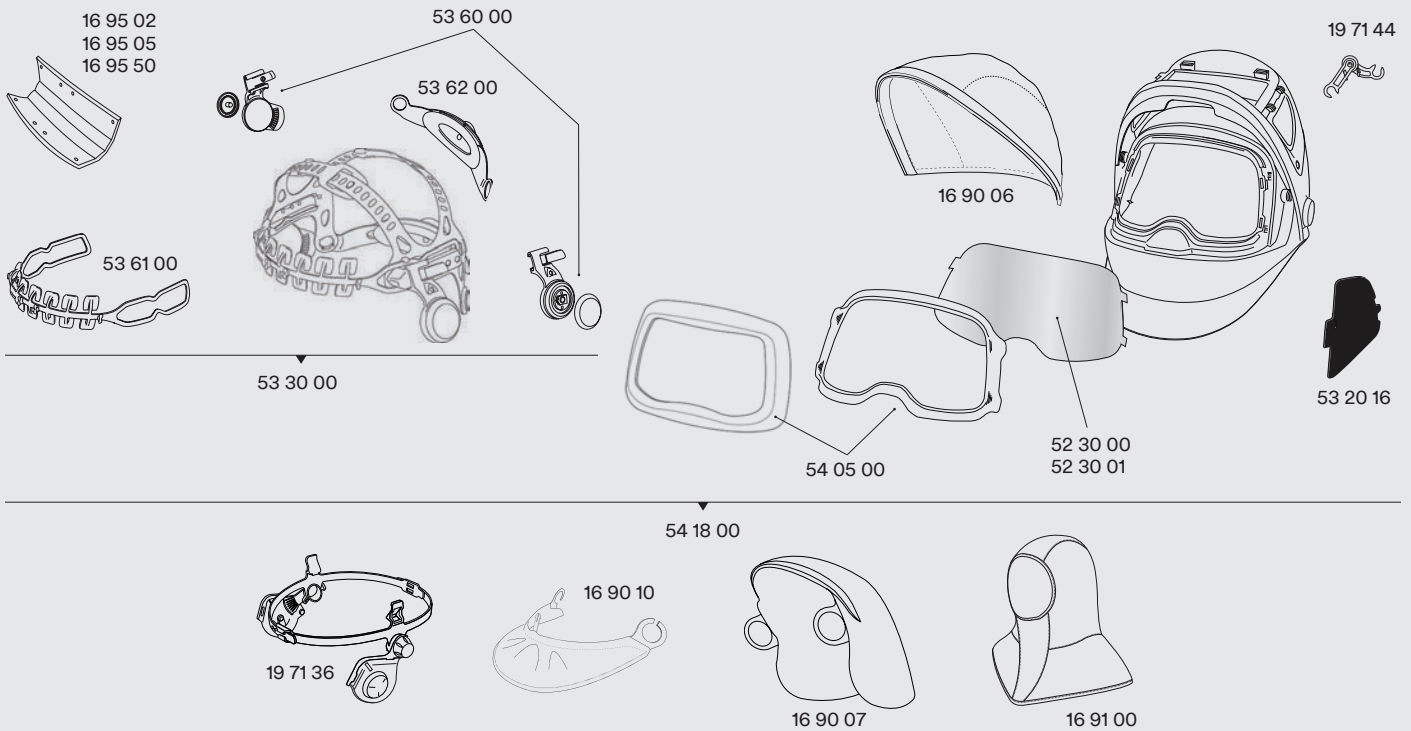

Auto-darkening lens

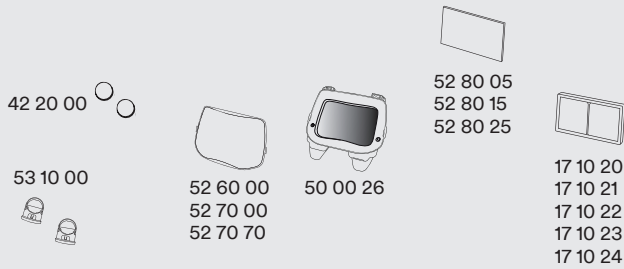

Passive lens option

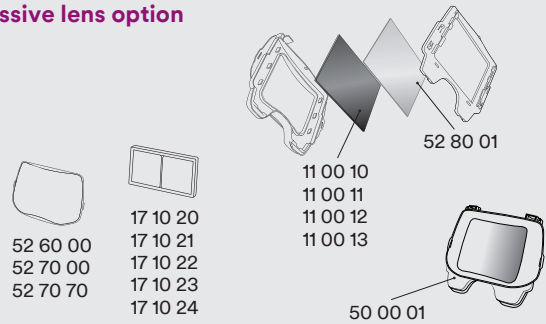

Part No	Description	Part No	Description	Part No	Description
11 00 10	Lens Welding Shade 10 Passive 90X110mm 9100	17 10 24	Lens Magnifying 3.0X 9100, 100 & 9000	52 80 25	Lens Cover Inner 9100XX/XXi Pk=5
11 00 11	Lens Welding Shade 11 Passive 90X110mm 9100	19 71 36	Attachment Hard Hat Speedyloop 9100 FX	53 10 00	Holder Battery 9100
11 00 12	Lens Welding Shade 12 Passive 90X110mm 9100	19 71 44	Flip Up Mechanism 9100 FX Pk=2	53 20 16	Sidewindows Cover Plate 9100 FX & MP Pk=2
11 00 13	Lens Welding Shade 13 Passive 90X110mm 9100	42 20 00	Battery Lithium 9100, 100 & 9000 Pk=2	53 30 00	Head Harness 9100
16 90 06	Head Cover Small 9100 FX	50 00 01	Lens Welding Filter 9100P Shade 11 Passive	53 60 00	Head Harness Pivot Mechanism 9100
16 90 07	Head Cover Large 9100 FX	50 00 26	Lens Welding 9100XXi Speedglas	53 61 00	Head Harness Front Part 9100
16 90 10	Throat Protection 9100	52 30 00	Visor Plate 9100 FX & MP Pk=5	53 62 00	Head Harness Back Part 9100
16 91 00	Head Cape Tecaweld	52 30 01	Visor Plate Anti-Fog 9100 FX & MP Pk=5	54 05 00	Front Cover Kit 9100 FX & MP
16 95 02	Sweatband 9100 & 9100 FX Pk=2	52 60 00	Lens Cover Outer Standard 9100 Pk=10	54 18 00	Helmet Welding Exc Lens 9100 FX
16 95 05	Sweatband 9100 & 9100 FX Pk=5	52 70 00	Lens Cover Outer Hard Coated 9100 Pk=10		
16 95 50	Sweatband 9100 & 9100 FX Pk=50	52 70 70	Lens Cover Outer High Heat 9100 Pk=10		
17 10 20	Lens Magnifying 1.0X 9100, 100 & 9000	52 80 01	Lens Cover Inner 9100 Passive Pk=5		
17 10 21	Lens Magnifying 1.5X 9100, 100 & 9000	52 80 05	Lens Cover Inner 9100V Pk=5		
17 10 22	Lens Magnifying 2.0X 9100, 100 & 9000	52 80 15	Lens Cover Inner 9100X Pk=5		
17 10 23	Lens Magnifying 2.5X 9100, 100 & 9000				

# 3M™ Speedglas™ Welding 9100 QR



## Welding helmet with safety helmet

Part No	Description
50 36 26	Welding helmet 9100XXi QR - complete.

## Welding helmet without safety helmet

Part No	Description
50 26 26	Welding helmet 9100XXi QR excluding safety helmet, including welding lens.

## Auto-darkening welding lens

Part No	Description
50 00 26	Speedglas 9100XXi welding lens.

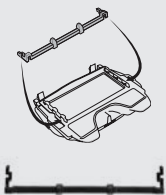

### Distance bar

We recommend using this distance bar (included when you buy a complete 9100 QR welding and safety helmet). Also sold as a spare part.

Part No 53 11 00



### Ear muff bar

For optimum comfort when using ear muffs, we recommend installing this ear muff bar.

Sold as a separate accessory.

Part No 53 31 00

Spare parts & accessories for 3M™ Speedglas™ Welding & Safety Helmet 9100 QR

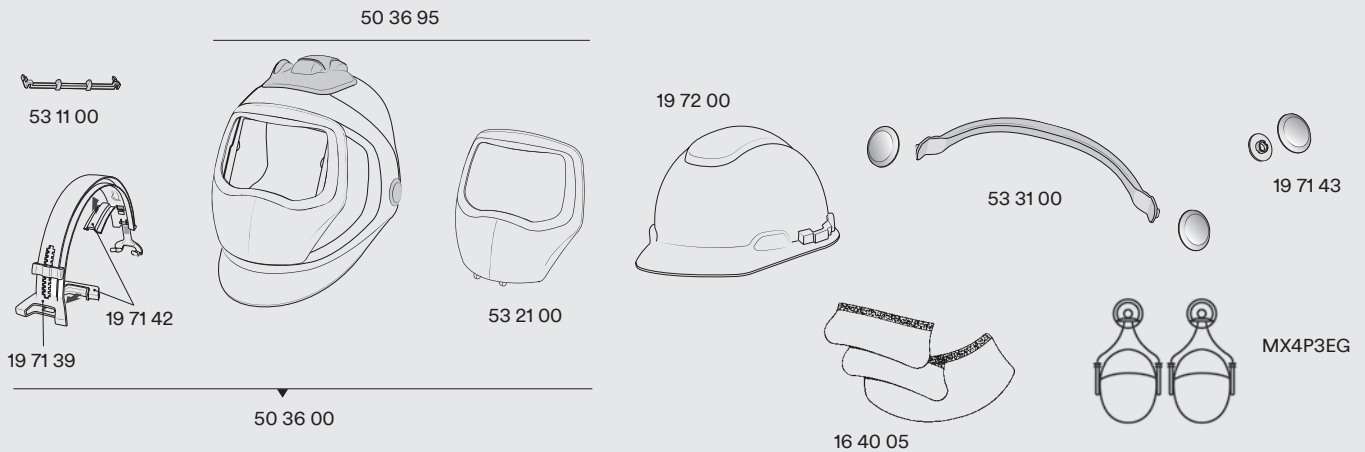

Auto-darkening lens

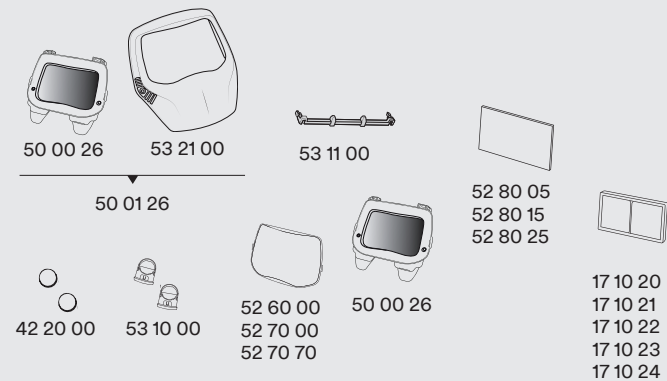

Passive lens option

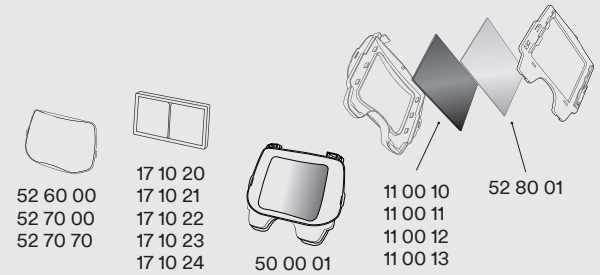

Part No	Description	Part No	Description	Part No	Description
11 00 10	Lens Welding Shade 10 Passive 90X110mm 9100	19 71 39	Rail QR	52 80 25	Lens Cover Inner 9100XX/XXi Pk=5
11 00 11	Lens Welding Shade 11 Passive 90X110mm 9100	19 71 42	Pads Rubber QR	53 10 00	Holder Battery 9100
11 00 12	Lens Welding Shade 12 Passive 90X110mm 9100	19 71 43	Pivot Cover Plate QR	53 11 00	Bar Distance 9100X & 9100XX QR
11 00 13	Lens Welding Shade 13 Passive 90X110mm 9100	19 72 00	Hard Hat White with Ratchet Harness 9100	53 21 00	Front Cover Silver 9100XXi
16 40 05	Ear/Throat Protection Leather 100 & 9000	42 20 00	Battery Lithium 9100, 100 & 9000 Pk=2	53 31 00	Bar Ear Muff 9100 QR
16 75 02	Sweatband Toweling 100 & 9000 Pk=2	50 00 01	Lens Welding Filter 9100P Shade 11 Passive	MX4P3EG	Earmuffs QR
16 75 05	Sweatband Toweling 100 & 9000 Pk=5	50 00 26	Lens Welding 9100XXi Speedglas		
16 75 50	Sweatband Toweling 100 & 9000 Pk=50	50 01 26	Lens Welding 9100XXi & Front Kit Speedglas		
17 10 20	Lens Magnifying 1.0X 9100, 100 & 9000	50 36 00	Helmet Welding Exc Lens & Hard Hat 9100 QR		
17 10 21	Lens Magnifying 1.5X 9100, 100 & 9000	50 36 95	Helmet Welding Exc Lens, Hard Hat & Rail 9100 QR		
17 10 22	Lens Magnifying 2.0X 9100, 100 & 9000	52 60 00	Lens Cover Outer Standard 9100 Pk=10		
17 10 23	Lens Magnifying 2.5X 9100, 100 & 9000	52 70 00	Lens Cover Outer Hard Coated 9100 Pk=10		
17 10 24	Lens Magnifying 3.0X 9100, 100 & 9000	52 70 70	Lens Cover Outer High Heat 9100 Pk=10		
		52 80 01	Lens Cover Inner 9100 Passive Pk=5		
		52 80 05	Lens Cover Inner 9100V Pk=5		
		52 80 15	Lens Cover Inner 9100X Pk=5		

# 3M™ Speedglas™ Welding Helmet 9100 Air



## Helmet systems with powered air

Part No	Description
50 77 26 <sup>1)</sup>	Speedglas 9100XXi Air welding helmet with standard Adflo powered air respirator - complete.
507726HD <sup>1)</sup>	Speedglas 9100XXi Air welding helmet with heavy duty Adflo powered air respirator - complete.

## Helmet system with supplied air

Part No	Description
50 88 26 <sup>1)</sup>	Speedglas 9100XXi Air welding helmet with Versaflo V-500E supplied air regulator - complete.

## Auto-darkening welding lens

Part No	Description
50 00 26	Speedglas 9100XXi welding lens.

## Maintenance tips for 3M™ Speedglas™ Welding Helmet 9100 Air

For Care & Maintenance information, posters and videos, visit our website at [www.awsi.com.au](http://www.awsi.com.au)



[www.awsi.com.au](http://www.awsi.com.au)



Adjust the air duct length for a personalised fit.



To provide protection the face seal must be in good condition. Do you know how to replace it?



Extend your head and neck coverage for additional protection from heat, sparks and splatter.

<sup>1)</sup> With storage bag (79 0101)

Spare parts & accessories for 3M™ Speedglas™ Welding Helmet 9100 Air

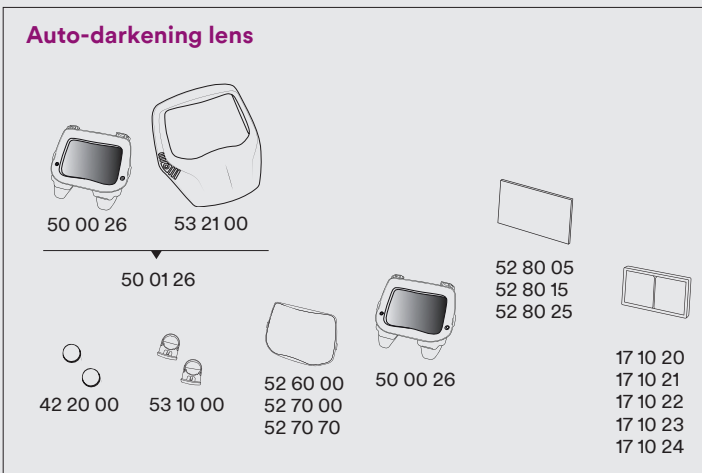
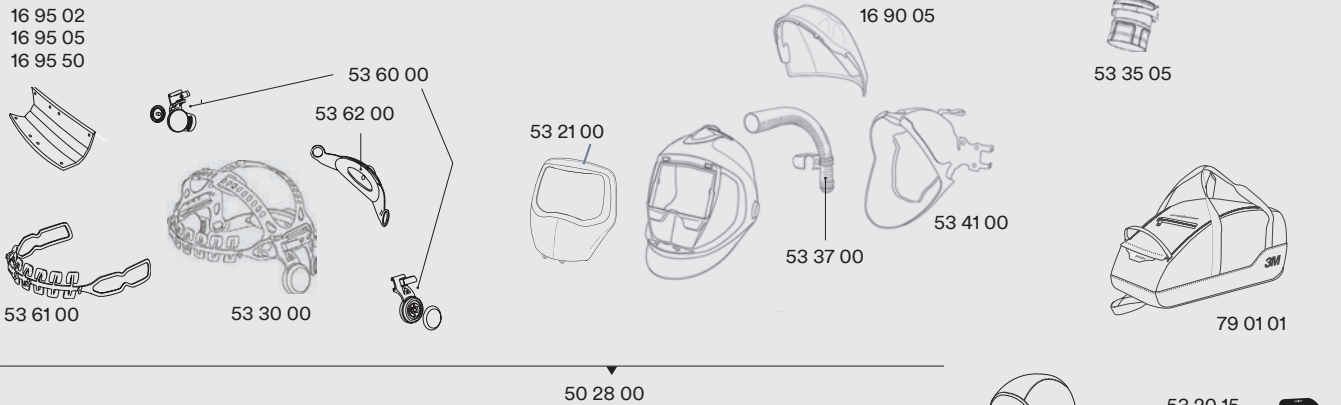

Part No	Description	Part No	Description	Part No	Description
16 90 05	Head Protection 9100	50 88 00	Speedglas 9100 Air with V-500E, Exc Welding Lens & Bag	79 01 01	Carry Bag Speedglas
16 90 10	Throat Protection 9100	50 90 26	Speedglas 9100XXi Air Upgrade Kit, Exc Adflo		
16 91 00	Head Cape Tecaweld	52 60 00	Lens Cover Outer Standard 9100 Pk=10		
16 95 02	Sweatband 9100 & 9100 FX Pk=2	52 70 00	Lens Cover Outer Hard Coated 9100 Pk=10		
16 95 05	Sweatband 9100 & 9100 FX Pk=5	52 70 70	Lens Cover Outer High Heat 9100 Pk=10		
16 95 50	Sweatband 9100 & 9100 FX Pk=50	52 80 05	Lens Cover Inner 9100V Pk=5		
17 10 20	Lens Magnifying 1.0X 9100, 100 & 9000	52 80 15	Lens Cover Inner 9100X Pk=5		
17 10 21	Lens Magnifying 1.5X 9100, 100 & 9000	52 80 25	Lens Cover Inner 9100XX/XXi Pk=5		
17 10 22	Lens Magnifying 2.0X 9100, 100 & 9000	53 10 00	Holder Battery 9100		
17 10 23	Lens Magnifying 2.5X 9100, 100 & 9000	53 20 15	Cover Plates SW 9100 Pk=2		
17 10 24	Lens Magnifying 3.0X 9100, 100 & 9000	53 21 00	Front Cover Silver 9100XXi		
42 20 00	Battery Lithium 9100, 100 & 9000 Pk=2	53 30 00	Head Harness 9100		
50 00 26	Lens Welding 9100XXi Speedglas	53 35 05	Adaptor Adflo Breathing Tube 9100 Air, FX Air, MP Air		
50 01 26	Lens Welding 9100XXi & Front Kit Speedglas	53 37 00	Air Duct Back Part 9100 Air		
50 28 00	Helmet Welding 9100 Air Exc Lens	53 41 00	Face Seal 9100 Air		
50 77 00	Speedglas 9100 Air with Adflo, Exc Welding Lens & Bag	53 60 00	Head Harness Pivot Mechanism 9100		
		53 61 00	Head Harness Front Part 9100		
		53 62 00	Head Harness Back Part 9100		



# 3M™ Speedglas™ Welding Helmet 9100 FX Air



## Helmet systems with powered air

Part No	Description
54 77 26 <sup>1)</sup>	Speedglas 9100XXi FX Air welding helmet with standard Adflo powered air respirator - complete.
547726HD <sup>1)</sup>	Speedglas 9100XXi FX Air welding helmet with heavy duty Adflo powered air respirator - complete.

## Helmet system with supplied air

Part No	Description
54 88 26 <sup>1)</sup>	Speedglas 9100XXi FX Air welding helmet with Versaflo V-500E supplied air regulator - complete.

## Auto-darkening welding lens

Part No	Description
50 00 26	Speedglas 9100XXi welding lens.

## Maintenance tips for 3M™ Speedglas™ Welding Helmet 9100 FX Air

For Care & Maintenance information, posters and videos, visit our website at [www.awsi.com.au](http://www.awsi.com.au)



[www.awsi.com.au](http://www.awsi.com.au)



It is important that the face seal is correctly installed and fitted to provide the correct protection factor.



Is your clear grinding visor not so clear anymore? Learn how to replace it at [www.awsi.com.au](http://www.awsi.com.au)



If you need additional protection for your head, watch how to install the large head cover.

Spare parts & accessories for 3M™ Speedglas™ Welding Helmet 9100 FX Air

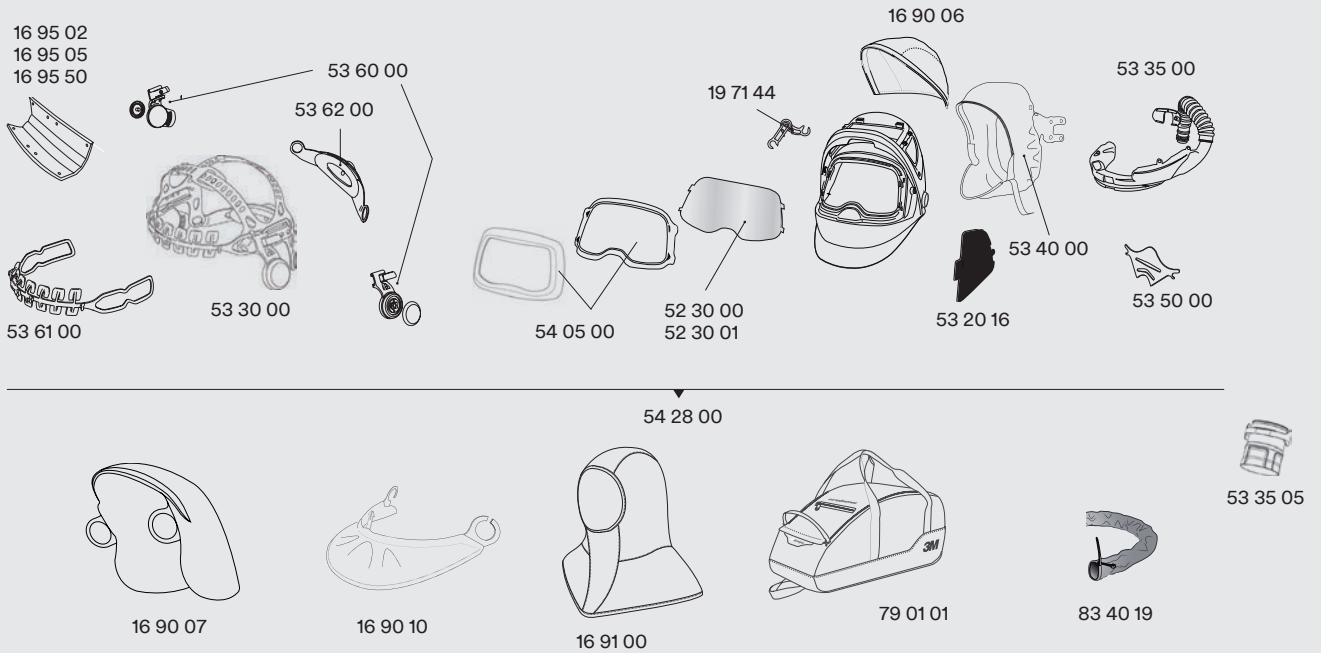

Auto-darkening lens

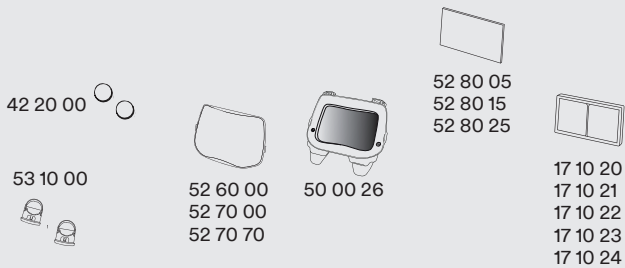

Passive lens option

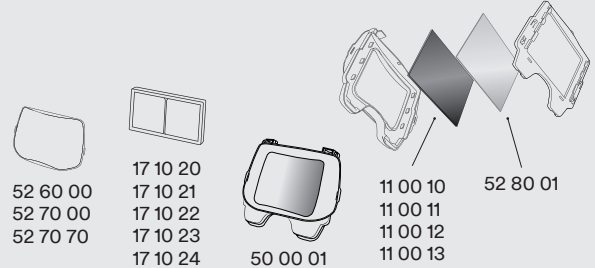

Part No	Description	Part No	Description	Part No	Description
11 00 10	Lens Welding Shade 10 Passive 90X110mm 9100	19 71 44	Flip Up Mechanism 9100 FX Pk=2	53 35 05	Adaptor Adflo Breathing Tube 9100 Air, FX Air & MP Air
11 00 11	Lens Welding Shade 11 Passive 90X110mm 9100	42 20 00	Battery Lithium 9100, 100 & 9000 Pk=2	53 40 00	Face Seal 9100 FX Air
11 00 12	Lens Welding Shade 12 Passive 90X110mm 9100	50 00 01	Lens Welding Filter 9100P Shade 11 Passive	53 50 00	Air Deflector 9100 FX Air
11 00 13	Lens Welding Shade 13 Passive 90X110mm 9100	50 00 26	Lens Welding 9100XXi Speedglas	53 60 00	Head Harness Pivot Mechanism 9100
16 90 06	Head Cover Small 9100 FX	52 30 00	Visor Plate 9100 FX & MP Pk=5	53 61 00	Head Harness Front Part 9100
16 90 07	Head Cover Large 9100 FX	52 30 01	Visor Plate Anti-Fog 9100 FX & MP Pk=5	53 62 00	Head Harness Back Part 9100
16 90 10	Throat Protection 9100	52 60 00	Lens Cover Outer Standard 9100 Pk=10	54 05 00	Front Cover Kit 9100 FX & MP
16 91 00	Head Cape Tecaweld	52 70 00	Lens Cover Outer Hard Coated 9100 Pk=10	54 28 00	Helmet Welding 9100 FX Air Exc Lens
16 95 02	Sweatband 9100 & 9100 FX Pk=2	52 70 70	Lens Cover Outer High Heat 9100 Pk=10	54 77 00	Speedglas 9100 FX Air with Adflo, Exc Welding Lens & Bag
16 95 05	Sweatband 9100 & 9100 FX Pk=5	52 80 01	Lens Cover Inner 9100 Passive Pk=5	54 88 00	Speedglas 9100 FX Air with V-500E, Exc Welding Lens & Bag
16 95 50	Sweatband 9100 & 9100 FX Pk=50	52 80 05	Lens Cover Inner 9100V Pk=5	54 90 26	Speedglas 9100XXi FX Air Upgrade Kit, Exc Adflo
17 10 20	Lens Magnifying 1.0X 9100, 100 & 9000	52 80 15	Lens Cover Inner 9100X Pk=5	79 01 01	Carry Bag Speedglas
17 10 21	Lens Magnifying 1.5X 9100, 100 & 9000	52 80 25	Lens Cover Inner 9100XX/XXi Pk=5	83 40 19	Breathing Tube Cover Flame Resistant 9100 FX Air
17 10 22	Lens Magnifying 2.0X 9100, 100 & 9000	53 10 00	Holder Battery 9100		
17 10 23	Lens Magnifying 2.5X 9100, 100 & 9000	53 20 16	SideWindows Cover Plate 9100 FX & MP Pk=2		
17 10 24	Lens Magnifying 3.0X 9100, 100 & 9000	53 30 00	Head Harness 9100		
		53 35 00	Air Duct Assembly 9100 FX Air		

# 3M™ Speedglas™ Welding Helmet 9100 MP Air



## Helmet systems with powered air

Part No	Description
57 77 26 <sup>1)</sup>	Speedglas 9100XXi MP Air welding and safety helmet with standard Adflo powered air respirator - complete.
577726HD <sup>1)</sup>	Speedglas 9100XXi MP Air welding and safety helmet with heavy duty Adflo powered air respirator - complete.

## Helmet system with supplied air

Part No	Description
57 88 26 <sup>1)</sup>	Speedglas 9100XXi MP Air welding and safety helmet with Versaflo V-500E supplied air regulator - complete.

## Auto-darkening welding lens

Part No	Description
50 00 26	Speedglas 9100XXi welding lens.

## Maintenance tips for 3M™ Speedglas™ Welding Helmet 9100 MP Air

For Care & Maintenance information, posters and videos, visit our website at [www.awsi.com.au](http://www.awsi.com.au)



[www.awsi.com.au](http://www.awsi.com.au)



Need to refresh the head protection on your 9100MP? Find out how to remove the safety helmet.



Learn how to install the heat-reflecting, silver helmet cover, helping to shield dust and particles from your helmet.



Need higher attenuation for your hearing protection, or is it just time to replace the old ones? See how to assemble the ear muffs in this video.

<sup>1)</sup> With storage bag (79 0101)

Spare parts & accessories for 3M™ Speedglas™ Welding Helmet 9100 MP Air

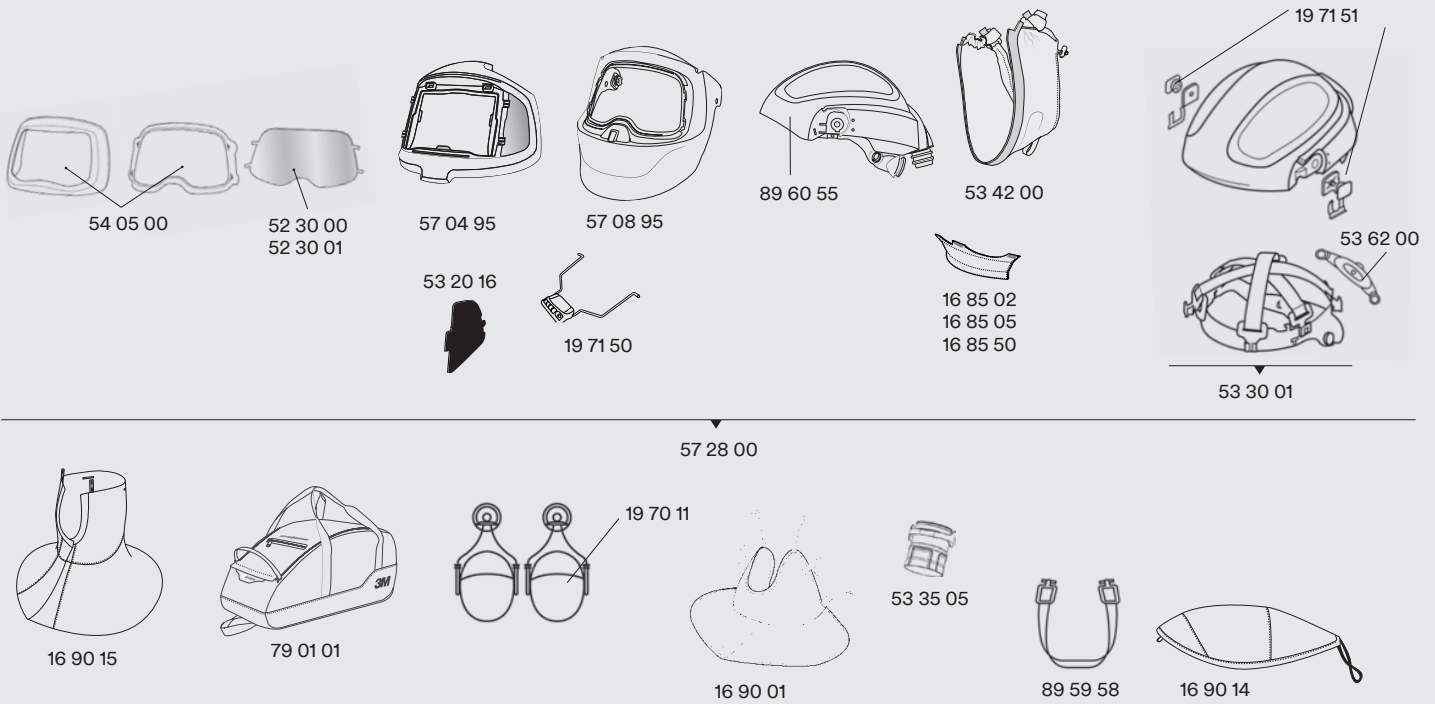

Auto-darkening lens

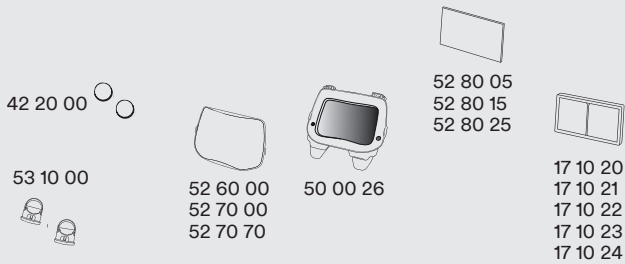

Passive lens option

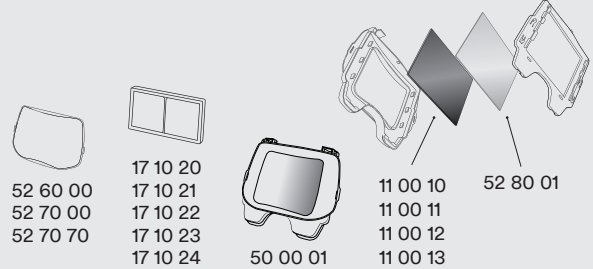

Part No	Description	Part No	Description	Part No	Description
11 00 10	Lens Welding Shade 10 Passive 90X110mm 9100	17 10 24	Lens Magnifying 3.0X 9100, 100 & 9000	53 10 00	Holder Battery 9100
11 00 11	Lens Welding Shade 11 Passive 90X110mm 9100	19 70 11	Earmuffs with Helmet Attachment 9100 MP	53 20 16	SideWindows Cover Plate 9100 FX & MP Pk=2
11 00 12	Lens Welding Shade 12 Passive 90X110mm 9100	19 71 50	Flip Up Mechanism 9100 MP	53 30 01	Head Harness 9100 MP
11 00 13	Lens Welding Shade 13 Passive 90X110mm 9100	19 71 51	Pivot Kit 9100 MP	53 35 05	Adaptor Adflo Breathing Tube 9100 Air, FX Air & MP Air
16 85 02	Sweatband 100, 9002NC, SL & 9100 MP Pk=2	42 20 00	Battery Lithium 9100, 100 & 9000 Pk=2	53 42 00	Face Seal 9100 MP
16 85 05	Sweatband 100, 9002NC, SL & 9100 MP Pk=5	50 00 01	Lens Welding Filter 9100P Shade 11 Passive	53 62 00	Head Harness Back Part 9100
16 85 50	Sweatband 100, 9002NC, SL & 9100 MP Pk=50	50 00 26	Lens Welding 9100XXi Speedglas	54 05 00	Front Cover Kit 9100 FX & MP
16 90 01	Throat Protection Tecaweld 100 & 9100 MP	52 30 00	Visor Plate 9100 FX & MP Pk=5	57 04 95	Shell Outer 9100 MP
16 90 01	Throat Protection Tecaweld 100 & 9100 MP	52 30 01	Visor Plate Anti-Fog 9100 FX & MP Pk=5	57 08 95	Shell Inner 9100 MP
16 90 14	Cover Hard Hat 9100 MP	52 60 00	Lens Cover Outer Standard 9100 Pk=10	57 28 00	Helmet Welding With Hard Hat 9100 MP
16 90 15	Shroud Helmet 9100 MP	52 70 00	Lens Cover Outer Hard Coated 9100 Pk=10	57 77 00	Speedglas 9100 MP Air with Adflo, Exc Welding Lens & Bag
17 10 20	Lens Magnifying 1.0X 9100, 100 & 9000	52 70 70	Lens Cover Outer High Heat 9100 Pk=10	57 88 00	Speedglas 9100 MP Air with V-500E, Exc Welding Lens & Bag
17 10 21	Lens Magnifying 1.5X 9100, 100 & 9000	52 80 01	Lens Cover Inner 9100 Passive Pk=5	57 90 26	Speedglas 9100XXi MP Air Upgrade Kit, Exc Adflo
17 10 22	Lens Magnifying 2.0X 9100, 100 & 9000	52 80 05	Lens Cover Inner 9100V Pk=5	79 01 01	Carry Bag Speedglas
17 10 23	Lens Magnifying 2.5X 9100, 100 & 9000	52 80 15	Lens Cover Inner 9100X Pk=5	89 59 58	Chin Strap Face Shield
		52 80 25	Lens Cover Inner 9100XX/XXi Pk=5	89 60 55	Hard Hat 9100 MP

# 3M™ Adflo™ Powered Air Purifying Respirator (PAPR)



**Respirator without headtop  
– standard battery**

Part No	Description
83 77 30	Adflo powered air respirator with standard battery - complete.



**Respirator without headtop  
– heavy duty battery**

Part No	Description
83 77 31	Adflo powered air respirator with heavy duty battery - complete.



## Standard battery upgrade kit

Don't get weighed down. A lightweight Lithium-ion battery designed for the Adflo respirator.

- Run time 8 hours<sup>1)</sup>
- Charging time 4.5 hours
- Compact and lightweight
- Rapid Charge (approx. 0-80% capacity in 1 hour)
- Kit includes new Li-ion standard battery and charger

**Part No: 83 76 30C**



## Heavy duty battery upgrade kit

A high-capacity Lithium-ion battery pack extends the operating hours of the respirator.

- Long run time 12 hours<sup>1)</sup>
- Charging time 5.5 hours
- Compact and lightweight
- Rapid Charge (approx. 0-80% capacity in 1 hour)
- Kit includes new Li-ion heavy duty battery and charger

**Part No: 83 76 31C**



## 3M™ Adflo™ Battery Charging Stand

The 6-position battery charging stand for Adflo battery chargers provides the ability to charge six batteries simultaneously - saving both time and hassle<sup>2)</sup>. Compatible with legacy Ni-MH batteries and the new Li-ion batteries. Flexible installation: either wall-mounted or stand-alone.

**Part No: 83 37 09**

<sup>1)</sup> Expected operating times are when using a new, fully-charged battery, new particle filter and a standard airflow setting.

<sup>2)</sup> Item does not include the battery chargers or batteries displayed. Batteries and chargers sold separately.

Spare parts & accessories for 3M™ Adflo™ Powered Air Respirator

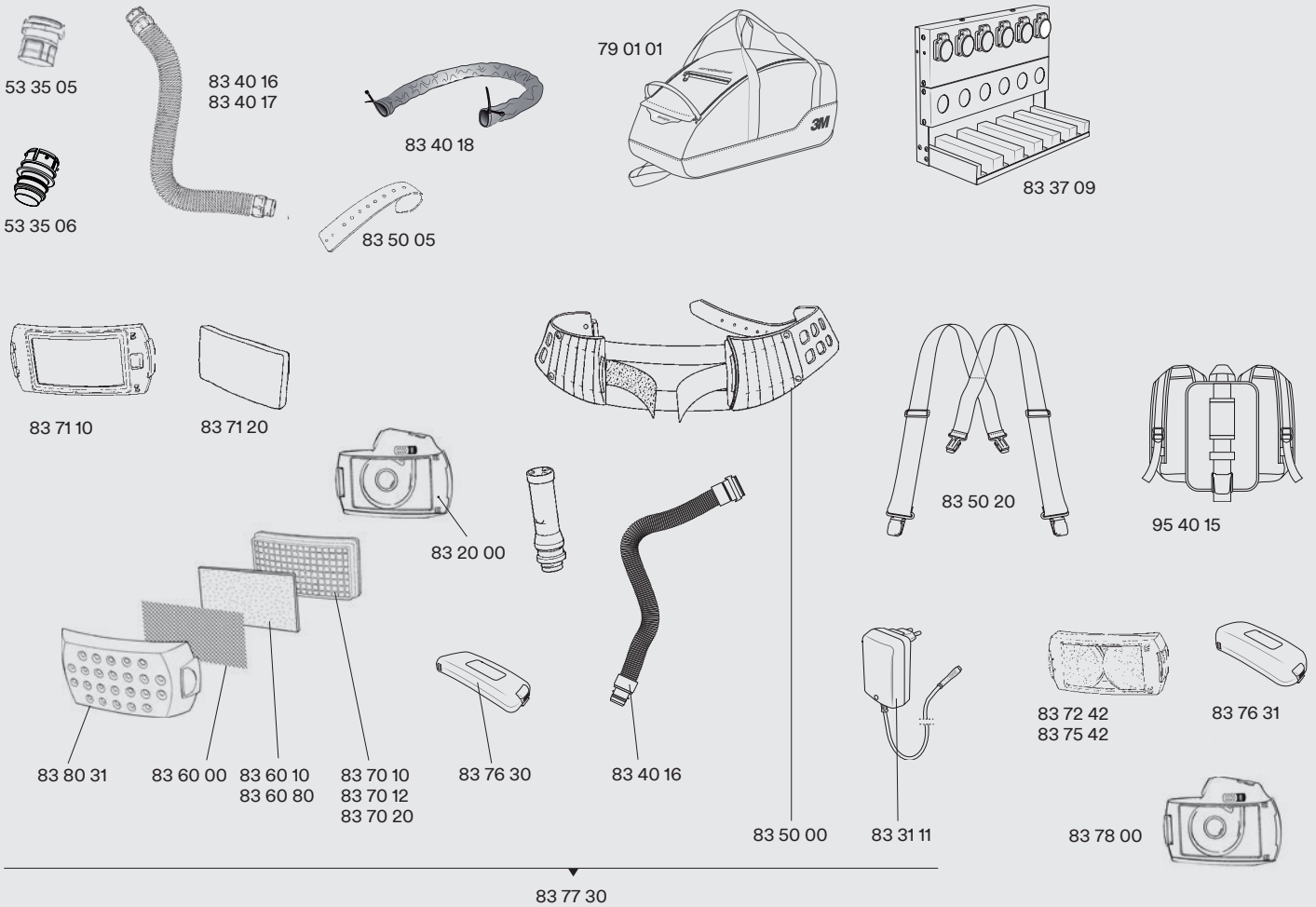

Part No	Description	Part No	Description	Part No	Description
53 35 05	Adaptor Adflo Breathing Tube 9100 Air, FX Air, MP Air	83 70 10	Filter Particle PSL Adflo	95 40 15	Backpack Adflo
53 35 06	Adaptor QRS Breathing Tube to 9000	83 70 12	Filter Particle PSL Adflo Pk=2		
79 01 01	Carry Bag Speedglas	83 70 20	Filter Particle PSL Adflo Pk=20		
80 60 20	Back Harness Adflo	83 71 10	Filter Odour Adflo		
83 20 00	PAPR Motor with Housing Adflo	83 71 20	Filter Odour Replacement Pad Adflo		
83 31 11 <sup>1)</sup>	Charger Battery Li-ion Adflo	83 72 42	Filter Nuis Level Organic Vapour/ Acid Gas Adflo		
83 37 09	Battery Multi-Station Adflo	83 75 42	Filter Gas A1 Adflo		
83 40 16	Tube Breathing Self Adjusting QRS Adflo	83 76 30 <sup>1)</sup>	Battery Standard Li-ion Adflo		
83 40 17	Tube Breathing Heavy Duty Rubber QRS Adflo	83 76 30C	Upgrade Kit Standard Li-ion Battery & Charger		
83 40 18	Tube Breathing Cover Flame Resistant Adflo	83 76 31 <sup>1)</sup>	Battery Heavy Duty Li-ion Adflo		
83 50 00	Belt Adflo	83 76 31C	Upgrade Kit Heavy Duty Li-ion Battery & Charger		
83 50 05	Belt Extension Adflo	83 77 30	Respirator Standard Li-ion Adflo		
83 50 20	Braces Adflo	83 77 31	Respirator Heavy Duty Li-ion Adflo		
83 60 00	Spark Arrestor Adflo	83 78 00	PAPR Motor with Housing Adflo High Altitude		
83 60 10	Pre-Filter Adflo Pk=5				
83 60 80	Pre-Filter Adflo Pk=80	83 80 31	Filter Cover Li-ion Adflo		

<sup>1)</sup> Lithium-ion (grey) batteries (83 76 30, 83 76 31) are only compatible with the Lithium-ion battery charger (83 31 11).

# 3M™ Versaflo™ Supplied Air Regulators



**Versaflo supplied air regulator V-500E**

Part No	Description
85 20 17	Versaflo V-500E regulator with belt.



**Vortex cooler personal air conditioner**

Part No	Description
AWS4590	Vortex cooler including muffler, with belt.

## Spare parts & accessories for 3M™ Versaflo™ Supplied Air Regulators

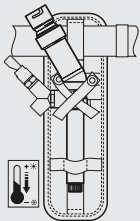

AWS4590

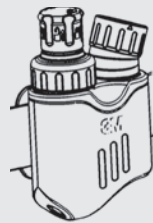
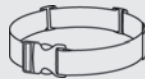

85 20 17

89 51 10



83 40 18

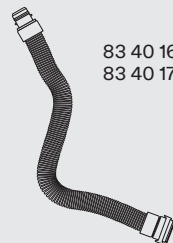

83 40 16  
83 40 17



53 35 06



- BAHOSE05M
- BAHOSE10M
- BAHOSE15M
- BAHOSE20M
- BAHOSE30M
- BAHOSE40M

Part No	Description
53 35 06	Adaptor QRS Breathing Tube to 9000
83 40 16	Tube Breathing Self Adjusting QRS Adflo
83 40 17	Tube Breathing Heavy Duty Rubber QRS Adflo
83 40 18	Tube Breathing Cover Flame Resistant Adflo
89 51 10	Carbon Filter and Two O-Rings SAR
85 20 17	Regulator V-500E with Belt
AWS4590	Vortex Cooler Inc Muffler With Belt

Part No	Description
BAHOSE05M	Hose Breathing Air 5M with CEJN Fittings
BAHOSE10M	Hose Breathing Air 10M with CEJN Fittings
BAHOSE15M	Hose Breathing Air 15M with CEJN Fittings
BAHOSE20M	Hose Breathing Air 20M with CEJN Fittings
BAHOSE30M	Hose Breathing Air 30M with CEJN Fittings
BAHOSE40M	Hose Breathing Air 40M with CEJN Fittings

# Breathing Air Filtration Systems

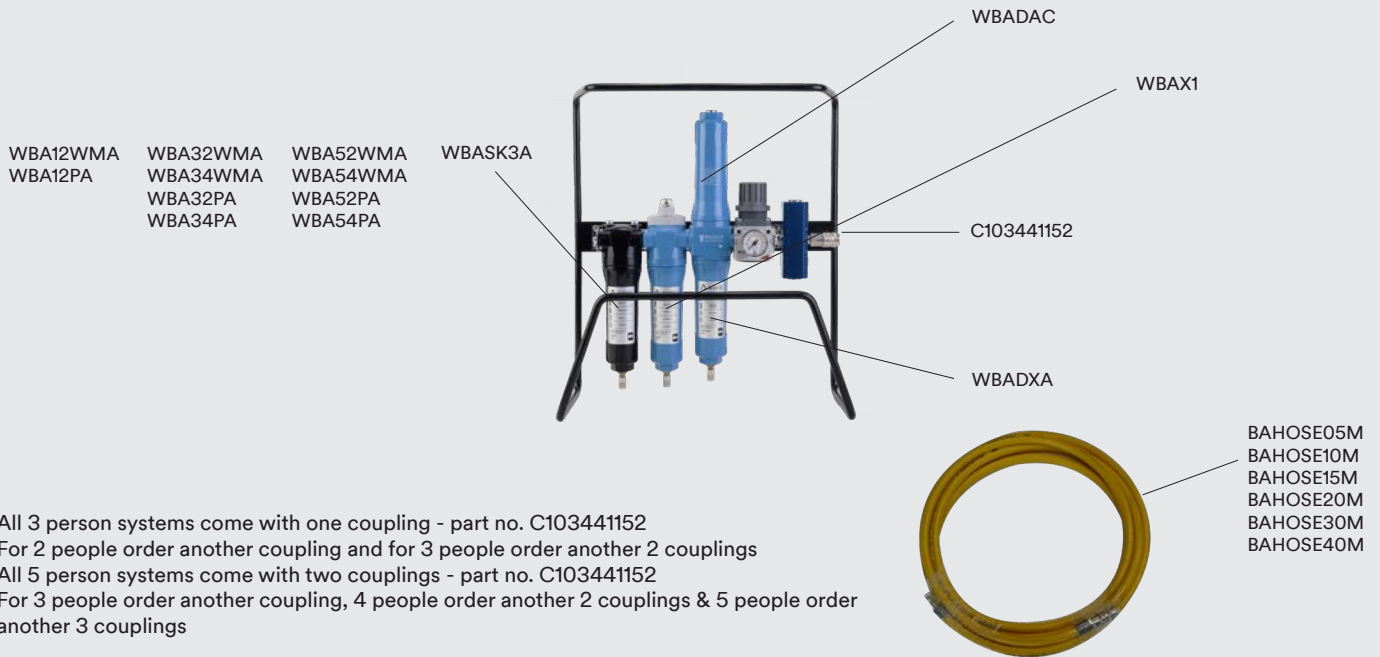

All 3 person systems come with one coupling - part no. C103441152  
 For 2 people order another coupling and for 3 people order another 2 couplings  
 All 5 person systems come with two couplings - part no. C103441152  
 For 3 people order another coupling, 4 people order another 2 couplings & 5 people order another 3 couplings

Part No	Description	Part No	Description
<b>NEW 2018 ALPHA BREATHING AIR SYSTEMS</b>		<b>HOSES</b>	
<b>WBA12WMA</b>	BA System 1 Person 2 Stage Wall Mount Alpha	<b>BAHOSE05M</b>	Hose Breathing Air 5M with CEJN Fittings
<b>WBA12PA</b>	BA System 1 Person 2 Stage Portable Alpha	<b>BAHOSE10M</b>	Hose Breathing Air 10M with CEJN Fittings
<b>WBA32WMA</b>	BA System 3 Person 2 Stage Wall Mount Alpha	<b>BAHOSE15M</b>	Hose Breathing Air 15M with CEJN Fittings
<b>WBA32PA</b>	BA System 3 Person 2 Stage Portable Alpha	<b>BAHOSE20M</b>	Hose Breathing Air 20M with CEJN Fittings
<b>WBA34WMA</b>	BA System 3 Person 4 Stage Wall Mount Alpha	<b>BAHOSE30M</b>	Hose Breathing Air 30M with CEJN Fittings
<b>WBA34PA</b>	BA System 3 Person 4 Stage Portable Alpha	<b>BAHOSE40M</b>	Hose Breathing Air 40M with CEJN Fittings
<b>WBA52WMA</b>	BA System 5 Person 2 Stage Wall Mount Alpha	<b>C103441152</b>	Coupling Male Thread R 1/4 BAS
<b>WBA52PA</b>	BA System 5 Person 2 Stage Portable Alpha	<b>PRE-2018 ELEMENTS</b>	
<b>WBA54WMA</b>	BA System 5 Person 4 Stage Wall Mount Alpha	<b>WBA058</b>	BA Element Water Spinner Filter
<b>WBA54PA</b>	BA System 5 Person 4 Stage Portable Alpha	<b>WBA3AC</b>	BA Element Activated Carbon (Upper) 1&3 Person
<b>NEW 2018 ELEMENTS</b>		<b>WBA3XA</b>	BA Element 0.01 Micron (Lower) 1&3 Person
<b>WBASK3A</b>	BA Element Water Spinner Filter Alpha	<b>WBA3X1</b>	BA Element 1 Micron Pre Filter 1&3 Person
<b>WBAX1</b>	BA Element 1 Micron Pre Filter Alpha	<b>WBA5AC</b>	BA Element Activated Carbon (Upper) 5 Person
<b>WBADXA</b>	BA Element 0.01 Micron (Lower) Alpha	<b>WBA5XA</b>	BA Element 0.01 Micron (Lower) 5 Person
<b>WBADAC</b>	BA Element Activated Carbon (Upper) Alpha	<b>WBA5X1</b>	BA Element 1 Micron Pre Filter 5 Person

## Supplied Breathing Air Process & Components



Air compressor



Breathing Air Hose



Breathing Air System



Breathing Air Hose



3M Speedglas welding helmet with supplied air regulator



# 3M™ Versaflo™ M-Series Headtops



**Spare parts & accessories for 3M™ Versaflo™ M-Series Headtops**

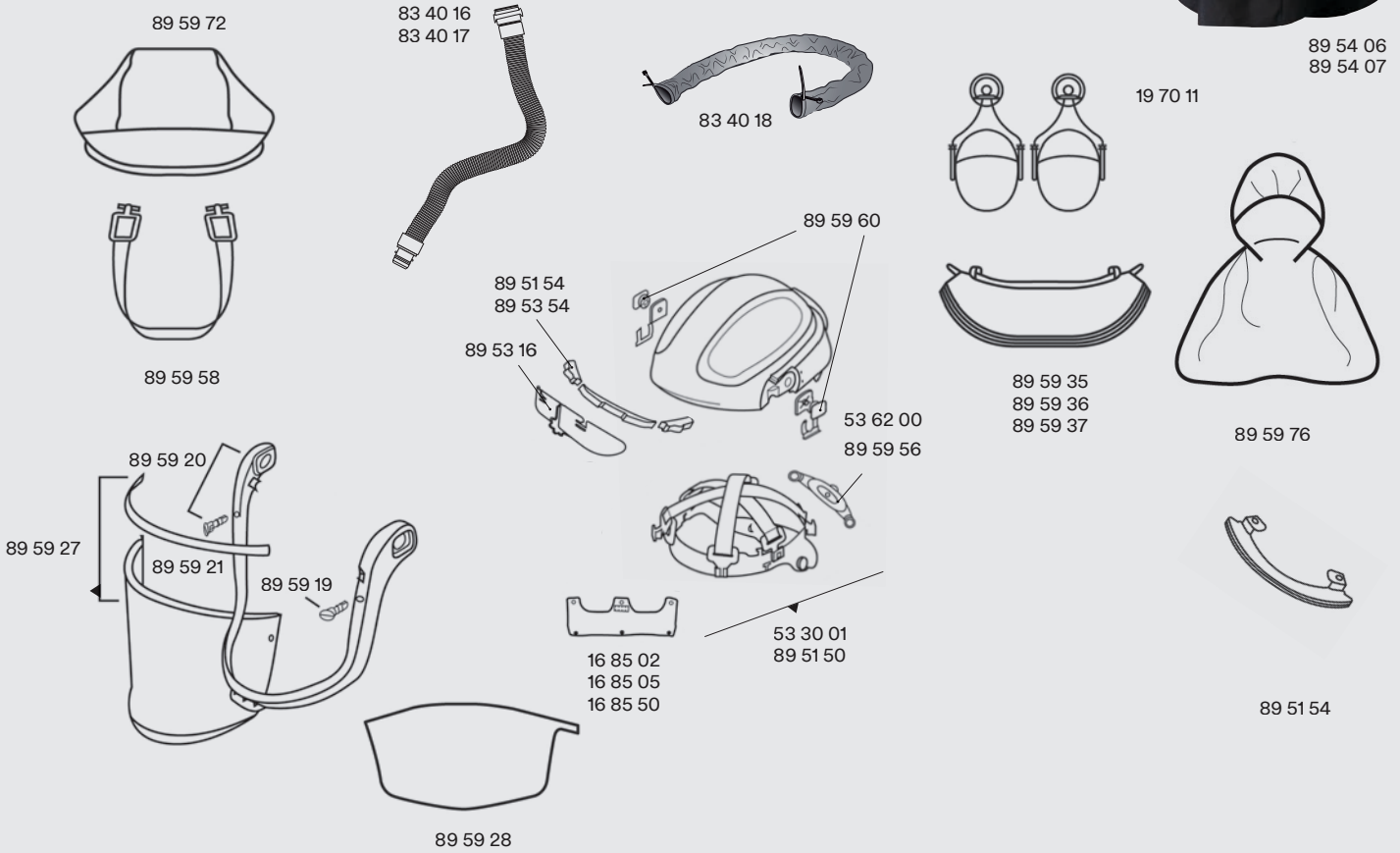

Part No	Description	Part No	Description	Part No	Description
16 85 02	Sweatband 100, 9002NC, SL & 9100 MP Pk=2	890407HD	Hard Hat Face Shield FR Shroud with Heavy Duty Adflo	89 54 48 <sup>1)</sup>	Shroud Outer FR M-400
16 85 05	Sweatband 100, 9002NC, SL & 9100 MP Pk=5	89 11 07	Face Shield FR Face Seal with V-500E SAR	89 59 19	Visor Frame Buttons Face Shield Pk=10
16 85 50	Sweatband 100, 9002NC, SL & 9100 MP Pk=50	89 13 07	Hard Hat Face Shield FR Face Seal with V-500E SAR	89 59 20	Visor Frame Face Shield
19 70 11	Earmuffs with Helmet Attachment 9100 MP, M-100, M-300	89 14 07	Hard Hat Face Shield FR Shroud with V-500E SAR	89 59 21	Visor Gasket Face Shield Pk=5
53 30 01	Head Harness 9100 MP, M-300, M-400	89 51 06	Face Shield with Std Face Seal	89 59 27	Visor Coated Face Shield Pk=5
53 62 00	Head Harness Back Part M-400	89 51 07	Face Shield with FR Face Seal	89 59 28	Peel-Off Visor Cover Face Shield Pk=40
83 40 16	Tube Breathing Self Adjusting QRS Adflo	89 51 50	Head Suspension 895107	89 59 35	Standard Face Seal Face Shield Pk=5
83 40 17	Tube Breathing Heavy Duty Rubber QRS Adflo	89 51 54	Forehead Seal 895107	89 59 36	Comfort Face Seal Face Shield Pk=5
83 40 18	Tube Breathing Cover Flame Resistant Adflo	89 51 70	Inserts Face Shield Head Pk=2	89 59 37	Flame Resistant Face Seal Face Shield Pk=5
89 01 07	Face Shield FR Face Seal with Adflo	89 53 06	Hard Hat Face Shield with Std Face Seal	89 59 56	Ratchet Comfort Pad Face Shield Pk=10
890107HD	Face Shield FR Face Seal with Heavy Duty Adflo	89 53 07	Hard Hat Face Shield with FR Face Seal	89 59 57	Comfort Pad Forehead Pk=20
89 03 07	Hard Hat Face Shield FR Face Seal with Adflo	89 53 16	Airflow Deflector 895307	89 59 58	Chin Strap Face Shield
890307HD	Hard Hat Face Shield FR Face Seal with Heavy Duty Adflo	89 53 54	Forehead Seal 895307	89 59 60	Pivot Kit Face Shield
89 04 07	Hard Hat Face Shield FR Shroud with Adflo	89 54 06	Hard Hat Face Shield with Std Shroud	89 59 72	Flame Resistant Headtop Cover Face Shield
		89 54 07	Hard Hat Face Shield with FR Shroud	89 59 76 <sup>2)</sup>	Head, Neck & Shoulder Cover Face Shield
		89 54 41	Gasket Jaw M-400		
		89 54 44	Collar Inner M-400		
		89 54 47 <sup>1)</sup>	Shroud Outer High Durability M-400		

1) Shrouds are only suitable for use with M-400 Series headtops.

2) Cover is ideal for powder coating, paint spray, or similar applications. The 895976 is designed solely to keep the wearer clean and does not provide additional respiratory protection or flame resistance.

# 3M™ Speedglas™ Welding Helmet 9002NC



Helmet with auto-darkening lens	
Part No	Description
40 13 85	Speedglas 9002NC welding helmet - complete.

Flip-up helmet with auto-darkening lens	
Part No	Description
44 13 85	Speedglas 9002NC FlexView welding helmet - complete.

Auto-darkening welding lens	
Part No	Description
40 00 85	Speedglas 9002NC welding lens.

## Spare parts & accessories for 3M™ Speedglas™ Welding Helmet 9002NC

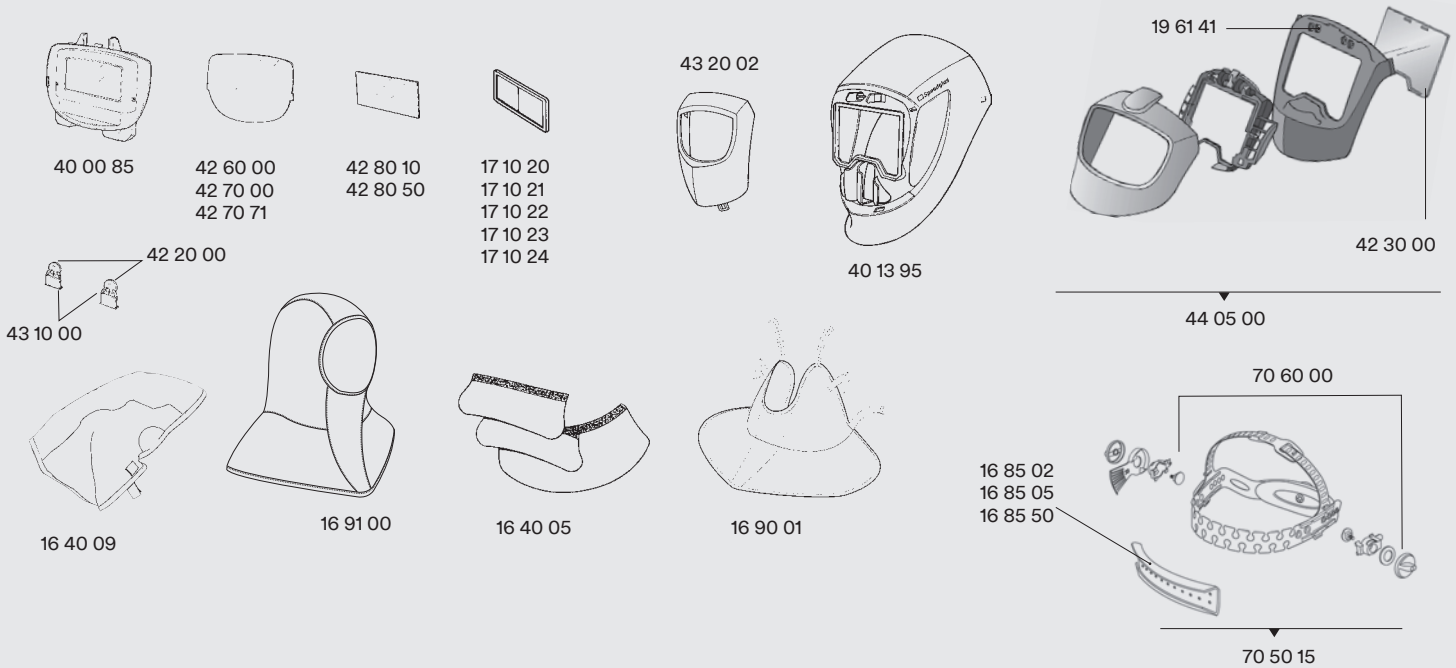

Part No	Description	Part No	Description	Part No	Description
16 40 05	Ear/Throat Protection Leather 100 & 9000	17 10 22	Lens Magnifying 2.0X 9100, 100 & 9000	42 70 00	Lens Cover Outer Hard Coated 9000 Pk=10
16 40 09	Head Protection Tecaweld 100 & 9000	17 10 23	Lens Magnifying 2.5X 9100, 100 & 9000	42 70 71	Lens Cover Outer High Heat 9000 Pk=10
16 85 02	Sweatband 100, 9002NC, SL & 9100 MP Pk=2	17 10 24	Lens Magnifying 3.0X 9100, 100 & 9000	42 80 10	Lens Cover Inner 9002X Pk=5
16 85 05	Sweatband 100, 9002NC, SL & 9100 MP Pk=5	19 61 41	Wedges Locking 9000 FlexView Pk=4	42 80 50	Lens Cover Inner Shade 2 9002X Pk=5
16 85 50	Sweatband 100, 9002NC, SL & 9100 MP Pk=50	40 00 85	Lens Welding Variable 9002NC Speedglas	43 10 00	Holder Battery 9000 Pk=2
16 90 01	Throat Protection Tecaweld 100 & 9100 MP	40 13 95	Shield Welding Exc Lens, Harness & Front 9002NC	43 20 02	Cover Front Silver 9002NC
16 91 00	Head Cape Tecaweld	42 20 00	Battery Lithium 9100, 100 & 9000 Pk=2	44 05 00	Conversion Kit 9000 FlexView
17 10 15	Magnifying Lens Attachments 9002NC Pk=2	42 30 00	Lens Cover 1.5mm 9000 FlexView Pk=10	70 50 15	Head Harness 100, SL & 9000
17 10 20	Lens Magnifying 1.0X 9100, 100 & 9000	42 60 00	Lens Cover Outer Standard 9000 Pk=10	70 60 00	Head Harness Attachments 100 & SL
17 10 21	Lens Magnifying 1.5X 9100, 100 & 9000				

# 3M™ Speedglas™ Welding Helmet Series 100



75 00 20

**Auto-darkening welding lens**

Part No	Description
75 00 20	Speedglas 100V welding lens.



**Ninja welding helmet**

Part No	Description
75 11 20	Speedglas 100V Ninja - complete.



**Trojan Warrior welding helmet**

Part No	Description
75 16 20	Speedglas 100V Trojan Warrior - complete.



**Xterminator welding helmet**

Part No	Description
75 22 20	Speedglas 100V Xterminator - complete.



**Ice Hot welding helmet**

Part No	Description
75 25 20	Speedglas 100V Ice Hot - complete.



**Skull welding helmet**

Part No	Description
75 28 20	Speedglas 100V Skull - complete.



**Motor welding helmet**

Part No	Description
75 29 20	Speedglas 100V Motor - complete.

## Frequently Asked Questions

Do you have a Speedglas question but can't seem to find the answer?

Visit our website to see our FAQ section!

Find out more about Speedglas plate markings, welding helmet classifications, how an auto-darkening welding lens works and more!

Visit [www.awsi.com.au/faq](http://www.awsi.com.au/faq)

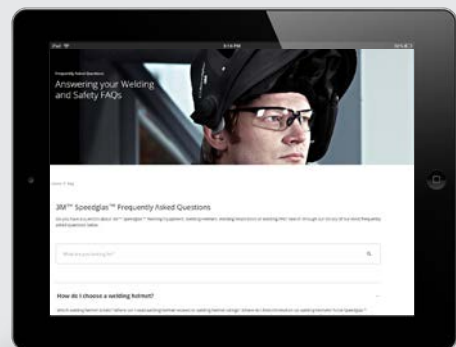

Spare parts & accessories for 3M™ Speedglas™ Welding Helmet Series 100

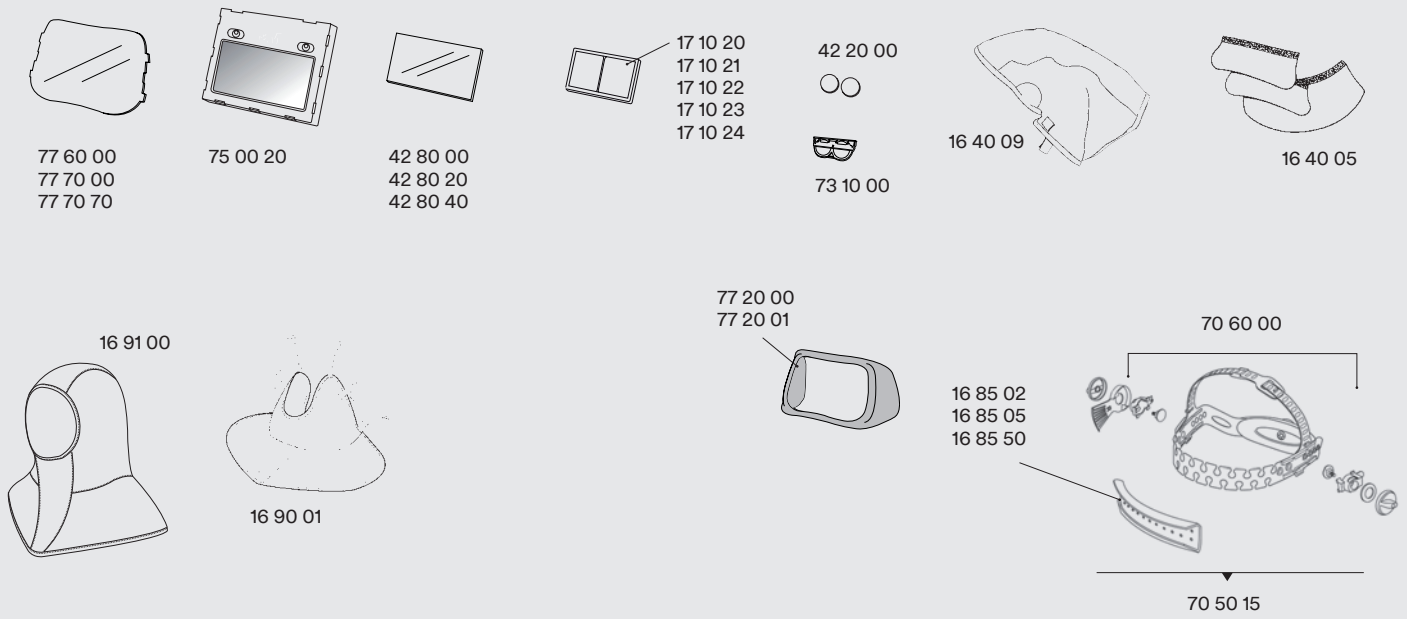

Part No	Description	Part No	Description	Part No	Description
16 40 05	Ear/Throat Protection Leather 100 & 9000	17 10 23	Lens Magnifying 2.5X 9100, 100 & 9000	77 60 00	Lens Cover Outer Standard 100 Pk=10
16 40 09	Head Protection Tecaweld 100 & 9000	17 10 24	Lens Magnifying 3.0X 9100, 100 & 9000	77 70 00	Lens Cover Outer Hard Coated 100 Pk=10
16 85 02	Sweatband 100, 9002NC, SL & 9100 MP Pk=2	42 20 00	Battery Lithium 9100, 100 & 9000 Pk=2	77 70 70	Lens Cover Outer High Heat 100 Pk=10
16 85 05	Sweatband 100, 9002NC, SL & 9100 MP Pk=5	42 80 00	Lens Cover Inner 100 & 9002V Pk=5		
16 85 50	Sweatband 100, 9002NC, SL & 9100 MP Pk=50	42 80 20	Lens Cover Inner Shade 1 100 Pk=5		
16 90 01	Throat Protection Tecaweld 100 & 9100 MP	42 80 40	Lens Cover Inner Shade 2 100 Pk=5		
16 91 00	Head Cape Tecaweld	70 50 15	Head Harness 100, SL & 9000		
17 10 20	Lens Magnifying 1.0X 9100, 100 & 9000	70 60 00	Head Harness Attachments 100 & SL		
17 10 21	Lens Magnifying 1.5X 9100, 100 & 9000	73 10 00	Holder Battery 100, 10V & SL		
17 10 22	Lens Magnifying 2.0X 9100, 100 & 9000	75 00 20	Lens Welding 100V Speedglas		
		77 20 00	Cover Front Silver 100		
		77 20 01	Cover Front Black 100		

## Thinking of upgrading?

The new 3M Speedglas Welding Helmet 9002NC has arrived! The helmet that changed everything is now available with an upgraded True-View welding lens.

- Large 55 × 107mm viewing area
- Lightweight at just 485 grams
- Upgrade to True-View for colour and contrast
- Slim, narrow profile welders know and love

See page 31 for more details



# 3M™ Welding Helmet 10V



### Helmet with auto-darkening lens

Part No	Description
10 11 10	3M 10V welding helmet - complete.

### Auto-darkening welding lens

Part No	Description
10 00 10	3M 10V welding lens.

### Spare parts & accessories for 3M™ Welding Helmet 10V

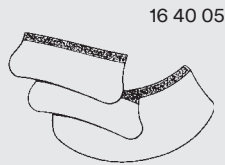
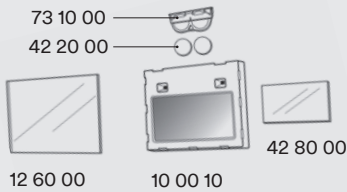
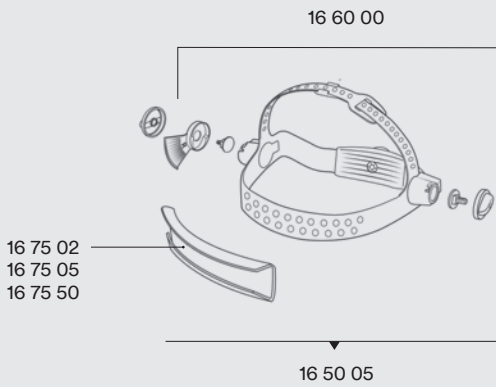

Part No	Description	Part No	Description	Part No	Description
10 00 10	Lens Welding Variable 10V	16 75 02	Sweatband Toweling 100 & 9000 Pk=2	42 80 00	Lens Cover Inner 100 & 9002V Pk=5
10 11 95	Shell Welding Exc Lens & Harness 10	16 75 05	Sweatband Toweling 100 & 9000 Pk=5	73 10 00	Holder Battery 100, 10V & SL
12 60 00	Lens Cover Outer 10 90X110X1mm Pk=2	16 75 50	Sweatband Toweling 100 & 9000 Pk=50		
16 40 05	Ear/Throat Protection Leather 100 & 9000	42 20 00	Battery Lithium 9100, 100 & 9000 Pk=2		
16 50 05	Head Harness 10				
16 60 00	Attachments Head Harness 10				

# 3M™ Speedglas™ Welding Helmet SL



Spare parts & accessories for 3M™ Speedglas™ Welding Helmet SL

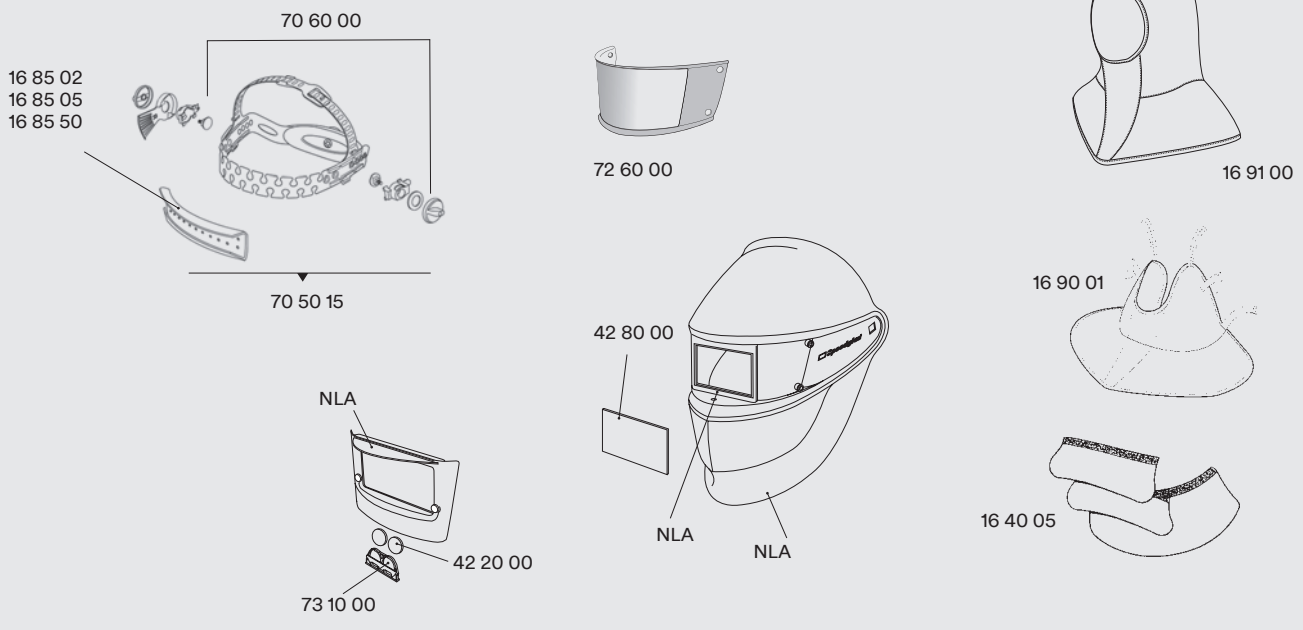

Part No	Description	Part No	Description	Part No	Description
16 40 05	Ear/Throat Protection Leather 100, SL & 9000	16 90 01	Throat Protection Tecaweld 100, SL & 9100 MP	70 60 00	Head Harness Attachments 100 & SL
16 85 02	Sweatband 100, 9002NC, SL & 9100 MP Pk=2	16 91 00	Head Cape Tecaweld	72 60 00	Lens Cover Outer Standard Frosted SL Pk=5
16 85 05	Sweatband 100, 9002NC, SL & 9100 MP Pk=5	42 20 00	Battery Lithium 9100, 100, SL & 9000 Pk=2	73 10 00	Holder Battery 100, 10V & SL
16 85 50	Sweatband 100, 9002NC, SL & 9100 MP Pk=50	42 80 00	Lens Cover Inner 100, SL & 9002V Pk=5		
		70 50 15	Head Harness 100, SL & 9000		



# 3M™ Speedglas™ Welding Helmet Series 9000 for Respiratory Protection



**Spare parts & accessories for 3M™ Speedglas™ Respiratory Welding Helmets 9000**

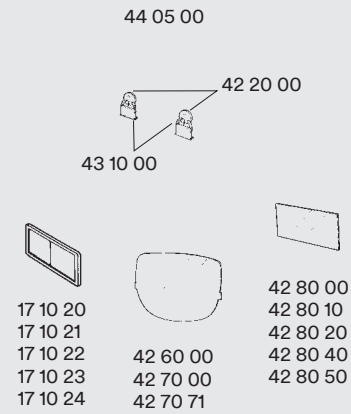
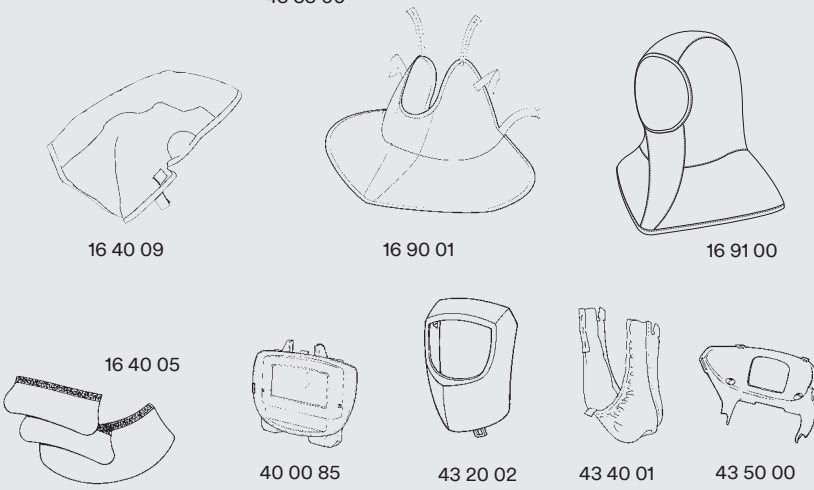
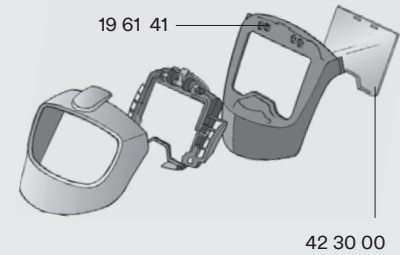
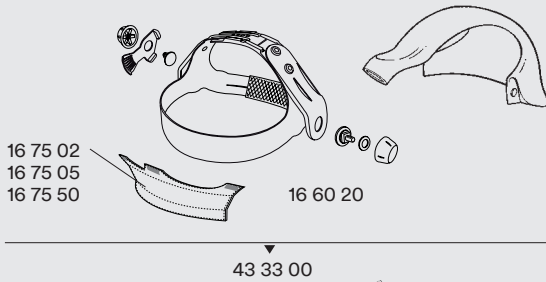

Part No	Description	Part No	Description	Part No	Description
16 40 05	Ear/Throat Protection Leather 100 & 9000	40 00 85	Lens Welding Variable 9002NC Speedglas	43 40 01	Face Seal for Welding Helmet 9000 Adflo/FAC
16 40 09	Head Protection Tecaweld 100 & 9000	42 20 00	Battery Lithium 9100, 100 & 9000 Pk=2	43 50 00	Air Spreader 9000 Adflo/FAC
16 60 20	Attachments Head Harness 9000	42 30 00	Lens Cover 1.5mm 9000 FlexView Pk=10	44 05 00	Conversion Kit 9000 FlexView
16 75 02	Sweatband Towelling 100 & 9000 Pk=2	42 60 00	Lens Cover Outer Standard 9000 Pk=10		
16 75 05	Sweatband Towelling 100 & 9000 Pk=5	42 70 00	Lens Cover Outer Hard Coated 9000 Pk=10		
16 75 50	Sweatband Towelling 100 & 9000 Pk=50	42 70 71	Lens Cover Outer High Heat 9000 Pk=10		
16 90 01	Throat Protection Tecaweld 100 & 9100 MP	42 80 00	Lens Cover Inner 100 & 9002V Pk=5		
16 91 00	Head Cape Tecaweld	42 80 10	Lens Cover Inner 9002X Pk=5		
17 10 20	Lens Magnifying 1.0X 9100 100 & 9000	42 80 20	Lens Cover Inner Shade 1 100 & 9002V Pk=5		
17 10 21	Lens Magnifying 1.5X 9100 100 & 9000	42 80 40	Lens Cover Inner Shade 2 100 & 9002V Pk=5		
17 10 22	Lens Magnifying 2.0X 9100 100 & 9000	42 80 50	Lens Cover Inner Shade 2 9002X Pk=5		
17 10 23	Lens Magnifying 2.5X 9100 100 & 9000	43 10 00	Holder Battery 9000 Pk=2		
17 10 24	Lens Magnifying 3.0X 9100 100 & 9000	43 20 02	Cover Front Silver 9002NC		
19 61 41	Wedges Locking 9000 FlexView Pk=4	43 30 00	Head Harness & Air Duct 9000 Adflo/FAC		

**Thinking of upgrading?**

**9100XXi FX Air headtop connects directly to your Adflo PAPR**

Part No	Description
54 90 26	3M Speedglas 9100XXi FX Air Upgrade Kit. Includes helmet, welding lens, QRS hose and carry bag.

# 3M™ Speedglas™ Welding Helmets FlexView / ProTop / Utility



## Spare parts & accessories for 3M™ Speedglas™ Welding Helmets FlexView / ProTop / Utility

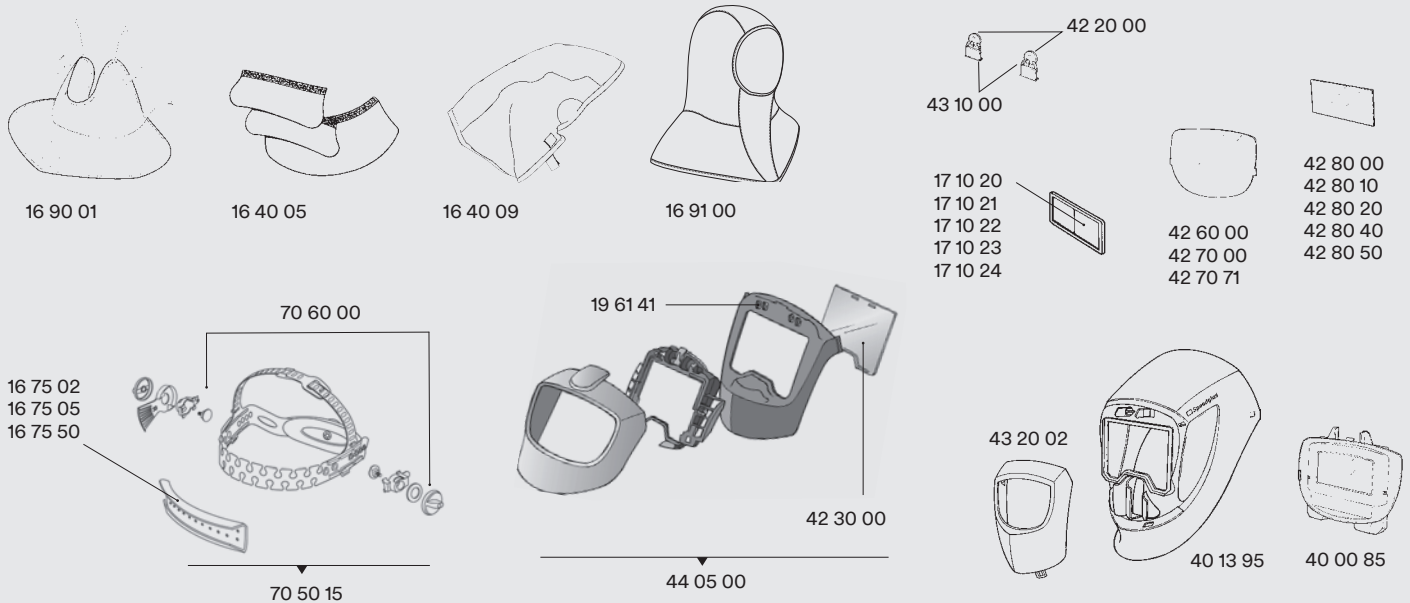

Part No	Description	Part No	Description
16 40 05	Ear/Throat Protection Leather 100 & 9000	40 13 95	Shield Welding Exc Lens, Harness & Front 9002NC
16 40 09	Head Protection Tecaweld 100 & 9000	42 20 00	Battery Lithium 9100, 100 & 9000 Pk=2
16 75 02	Sweatband Towelling 100 & 9000 Pk=2	42 30 00	Lens Cover 1.5mm 9000 FlexView Pk=10
16 75 05	Sweatband Towelling 100 & 9000 Pk=5	42 60 00	Lens Cover Outer Standard 9000 Pk=10
16 75 50	Sweatband Towelling 100 & 9000 Pk=50	42 70 00	Lens Cover Outer Hard Coated 9000 Pk=10
16 90 01	Throat Protection Tecaweld 100 & 9100 MP	42 70 71	Lens Cover Outer High Heat 9000 Pk=10
16 91 00	Head Cape Tecaweld	42 80 00	Lens Cover Inner 100 & 9002V Pk=5
17 10 20	Lens Magnifying 1.0X 9100 100 & 9000	42 80 10	Lens Cover Inner 9002X Pk=5
17 10 21	Lens Magnifying 1.5X 9100 100 & 9000	42 80 20	Lens Cover Inner Shade 1 100 & 9002V Pk=5
17 10 22	Lens Magnifying 2.0X 9100 100 & 9000	42 80 40	Lens Cover Inner Shade 2 100 & 9002V Pk=5
17 10 23	Lens Magnifying 2.5X 9100 100 & 9000	42 80 50	Lens Cover Inner Shade 2 9002X Pk=5
17 10 24	Lens Magnifying 3.0X 9100 100 & 9000	43 10 00	Holder Battery 9000 Pk=2
19 61 41	Wedges Locking 9000 FlexView Pk=4	43 20 02	Cover Front Silver 9002NC
40 00 85	Lens Welding Variable 9002NC Speedglas	44 05 00	Conversion Kit 9000 FlexView
		70 50 15	Head Harness 100 & 9000
		70 60 00	Head Harness Attachments 100 & SL

## Thinking of upgrading?

Upgrade to new True-View with a quick release safety helmet

See page 21



Upgrade to new True-View and flip-up to reveal a huge clear, curved, grinding visor

See page 17





# Extra Protection & Accessories

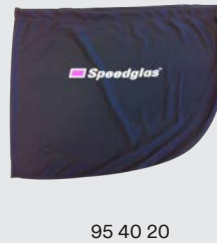
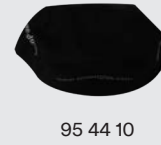

Part No	Description
16 90 05	Head Protection 9100
16 90 06	Head Cover Small 9100 FX
16 90 07	Head Cover Large 9100 FX
16 90 10	Throat Protection 9100
16 91 00	Head Cape Tecaweld
19 70 12	Earmuffs Welding Black Neckband
79 01 01	Carry Bag Speedglas
95 40 10	Speedglas Back Pack
95 40 20	Speedglas Helmet Drawstring Bag

Part No	Description
95 41 01	Speedglas Hoodie Medium
95 41 02	Speedglas Hoodie Large
95 41 03	Speedglas Hoodie Extra Large
95 44 10	Speedglas Welders Cap
95 44 11	Speedglas Bandana Welders Cap
M3121250	3M Earplugs Soft Neon Yellow Uncorded Box=200 Pairs
M7528	3M Welding Respirator Kit 7502, GP2 Protection
M9322A+	3M 9322A+ Disposable Respirators P2 Pk=10